

# S+B School Project Portfolio

*In this presentation, we showcase some of our recently completed educational projects.*

*Our International School clients are located all over the world. We work closely with several well-known school groups, such as Nord Anglia Education, GEMS, Cognita and Inspired Education, whilst also working directly with individual schools.*

*Our International school offering includes specialist laboratories, prep rooms, teaching walls, Food Technology, Art, DT and IT suites.*

*S+B are proud supporting members of BSME, CEESA, FOBISIA and COBIS.*

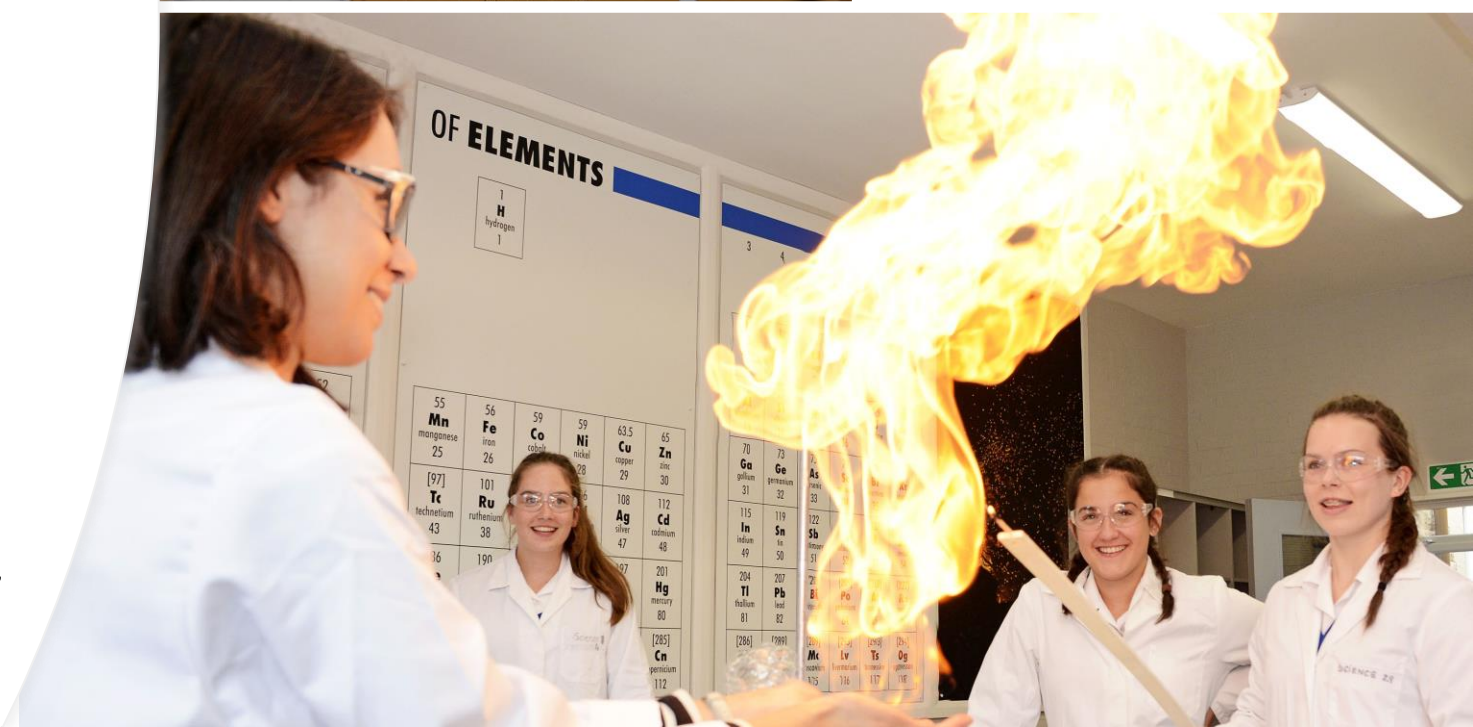

# Northfield Mount Herman School Massachusetts, USA

*S+B played an integral part in furnishing 10 school laboratories, 1 fab shop, and 5 preparation rooms/minilabs, thereby enhancing the center's capacity to promote collaboration and creativity among students and faculty.*

*The main objective was to provide furniture that would adapt to the ever-changing educational needs of NMH students.*

*This goal was achieved through versatile and adaptable furniture solutions. We supplied a range of furniture, including mobile student workstations, SpaceSaver teaching walls, and 7 fume cupboards.*



# Fontbonne Hall Academy

## New York, USA

*The School unveiled its state-of-the-art science suite comprising a research lab, chemistry/biology lab, physics lab, and a prep room, in 2022.*

*The installation included S+B's laboratory furniture system, such as SpaceStation, Saturn and Mercury, STEM islands, SpaceSaver working Wall, and Ecoline ducted fume cupboards.*

*The transformed science spaces now support collaborative teaching, learning, and research, providing students with an immersive hands-on experience that bridges the gap between classroom concepts and real-life applications.*



# Regis High School, New York City USA

*With an increased focus on creating STEM learning spaces, we were appointed by Regis High School to design and create several fully serviced practical spaces, that could be used for both traditional science disciplines and engineering.*

*Whilst the central islands accommodate practical science, the tall storage and perimeter workstations were designed to house heavy tooling for engineering use and to offer space for individual project work.*



# Miss Halls School Connecticut, USA

*Working with our S+B representative based in the USA, this high specification project involved the design and installation of seven laboratories.*

*Storage was maximised within each laboratory, through the inclusion of full height 'working walls'.*

*By creating localised equipment storage, teacher/technician movement between prep room and laboratory is significantly reduced, which in turn leads to much more efficient lesson planning.*



# Bishop Stang High School *Massachusetts, USA*

*S+B supplied and installed the furniture for the school's Chemistry, Biology and Physics Labs.*

*The laboratory furniture provided was Stemline Workstations with under bench storage and fitted services and StemLine Student Desks with a drop leaf that provide additional worktop space when needed.*

*The client benefited from the clear translation of proposed solutions through the use of 3D visualizations produced by the design team.*



# American International School Bucharest, Romania

*The client brief for this refurbishment project was to create two brand new, STEM teaching and learning spaces.*

*The focus of this design was to provide a group working environment, fostering collaboration between students.*

*Each workstation is fully equipped with services including gas, power & data provisions, as well as a centralised sink position.*



# American International School of Budapest

*Budapest, Hungary*

*After long consultations with the School and a couple of site visits, we designed and installed laboratories to the exact requirements of each teacher and each subject matter.*

*With University style Research benches and spacesaving storage walls this school now has laboratories perfectly set up to prepare their students for higher education in STEM.*





# Nord Anglia International School *Hong Kong, Asia*

*As a Nord Anglia preferred supplier, we have had the opportunity to work on several schools over the past 10 years. On this project, we worked closely with Head Teacher Brian Cooklin to create a unique and inspiring design, utilising the S+B 'Spacestation' system.*

*Each laboratory was equipped with full width teaching walls, seamless Corian worksurfaces and S+B 'Mobiline' fume cupboards.*



# British International School Kuala Lumpur, Malaysia

*This varied project, spilt over two phases, including the design and installation of several laboratories, a food technology suite, IT suite, and a large design technology/STEM space.*

*A light and bright design brief led to the use of multiple colours, resulting in engaging and inviting practical spaces for students and teachers alike!*



# British International School of Tbilisi

*Tbilisi, Georgia*

---

*One of our repeat customers, we have worked with this school on three separate occasions, delivering several laboratories within each phase, and one more to go!*

*Each laboratory is equipped with either our “Spacestation” or “Saturn & Mercury” systems, both of which have been created to entice students into the Sciences, through exciting and aesthetically appealing design.*

*We have a fantastic time-lapse video of this installation on our Youtube page.*



# Apex 2100

## Tignes, France

*An incredible project to be involved with, rarely do we get the opportunity to work with an International Ski Academy!*

*Apex 2100 offers its students state of the art training and rehabilitation areas, alongside world leading academic facilities.*

*S+B UK were commissioned to design and install two laboratories for this school, and it remains one of our most unique projects to date.*

*Former rugby player and coach, Sir Clive Woodward is the Director of Sport at this prestigious Academy.*



# Kings College

## Bangkok, Thailand

*This excellent project involved the supply of laboratories, STEM facilities & prep rooms.*

*Opting for our 'Xenium' service tower and table system, the school can easily reposition the furniture, moving from a forward-facing theory-based arrangement, to a group working practical layout.*

*This flexibility allows the school to use each laboratory in a variety of ways and teach more than just science, meeting the increasing demand for futureproofed facilities.*



# Concord College

## Shrewsbury, UK

*Concord College is a leading British International school and has been named as one of the top 10 STEM schools in the UK!*

*S+B worked closely with the client team to develop the complete specification for their brand-new science block, which comprised of 24 laboratories and several supporting prep rooms.*

*Influenced by S+B standard systems, yet totally unique to the needs of the teachers, who were involved throughout the entire design process!*



# International School of Helsinki, *Helsinki, Finland*

*Our first project in Finland and another Spacestation scheme!*

*Our first meeting with the client team was at a CEESA conference in Poland, where we were able to present our various furniture systems.*

*The Spacestation design was the preferred option and combined with a unique colour scheme, we were able to transform their existing laboratories into modern and attractive learning environments.*



# The British School of Tashkent – Nord Anglia *Uzbekistan*

*In November 2020 the BST launched a state-of-the-art STEAM Centre dedicated to the next generation of Scientists, Engineers, Mathematicians and Artists, a learning environment that allows students to learn by inventing, creating and designing—and understanding the true meaning of design.*

*S+B manufactured and supplied Xenium Service Towers and SpaceStation and Saturn furniture systems for the three science laboratories located in the new building.*





# Shrewsbury International School Bangkok, Thailand

*Here we supplied bespoke furniture systems and fume cupboards for 18 science laboratories and 3 preparation rooms, as part of the school's "Project 2021", a 1.1 billion THB construction project.*

*The high specification labs, each with an average of 120 sqm, specially designed island benches with incorporated storage as well as our popular "Saturn and Mercury" System, teacher's demo desks and Teaching Walls.*



# College Alpin Beau Soleil

*Villars-sur-Ollon, Switzerland*

*Another Nord Anglia project, the school chose our “Saturn & Mercury” system for their labs with light and bright colours to reflect their snowy surroundings in the Swiss Alps.*

*These labs were an instant hit with the students who love to use them, especially for practical experiments as you can see in the images!*



# Lady Eleanor Holles School

*Foshan, China*

*For this project we worked with the founding headmaster Steve Allen to design 5 unique laboratories to bring something new to the International Education system in China.*

*The Labs included our “Spacestation”, “STEMline”, and “Saturn & Mercury” systems as well as a highly bespoke preparation area.*

*The labs received widespread attention from the community of International Schools in Foshan.*



# Wellington College

## *Bangkok, Thailand*

*The College's new Senior School Building houses state-of-the-art facilities in which each learning space is unique.*

*The newly installed S+B science laboratories and preparation room have custom-made Crescent island benches that not only look stunning but fit the school's educational philosophy.*

*The Teaching walls with integrated smartboards an excellent example of creating space-efficient storage solutions that serve a dual purpose.*



# Recently awarded projects

- *KIS International School, Bangkok*
  - *An independent International School which is building a brand new campus which hopes to be the best School campus in Bangkok.*
- *Aiglon College, Switzerland*
  - *Located in the beautiful village of Villars-sur-Ollon about an hours drive from Geneva, this school boasts being one of the most prestigious boarding schools in the world.*
- *British School, Barcelona*
  - *This project will involve the installation of the S+B “Spacestation” and “Saturn & Mercury” systems. Located in the city centre of Barcelona!*

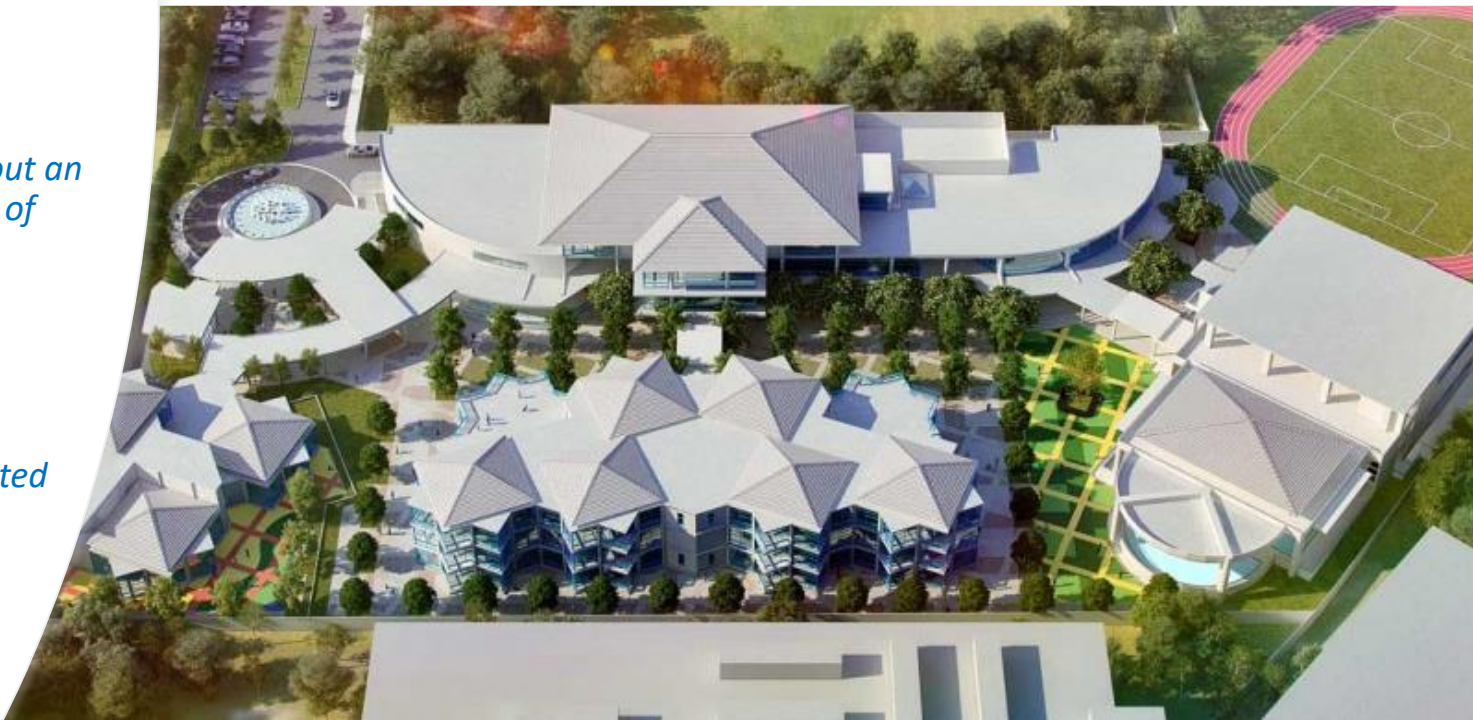

# Recently awarded projects

- *Brighton College, Hanoi, Vietnam*
  - *A Vin Group School and part of Brighton College International, this is the first of 7 new Brighton Schools to be built across Vietnam.*
- *The English Montessori School, Madrid*
  - *A Cognita School in the heart of Madrid, this is one of 5 Cognita projects S+B will be involved in during 2023-24*
- *International School Rheintal, Switzerland*
  - *This project requires the installation of three high specification laboratories and a prep room, with fume cupboards and chemical storage.*



# Recently awarded projects

- *British International School, Timisoara, Romania*
  - *A second phase of labs for S+B at this school, BIST were so pleased with their original labs that they decided to add 3 more!*
- *West Island School, Hong Kong*
  - *Part of the “English Schools Foundation” in Hong Kong this is the 3<sup>rd</sup> School and 4<sup>th</sup> project for S+B in partnership with the ESF.*
- *Kings College, The Bahamas*
  - *This School is the flagship school for the “Inspired Education” group, having worked with Inspired at Kings College Panama previously, KCB chose S+B once more..*

